

## ORTRAND TILE STOVES



# E4020.61

State: 2023-08-30



**BRUNNER**<sup>®</sup>  
*made in germany.*

## Dimension sheets - E4020.61

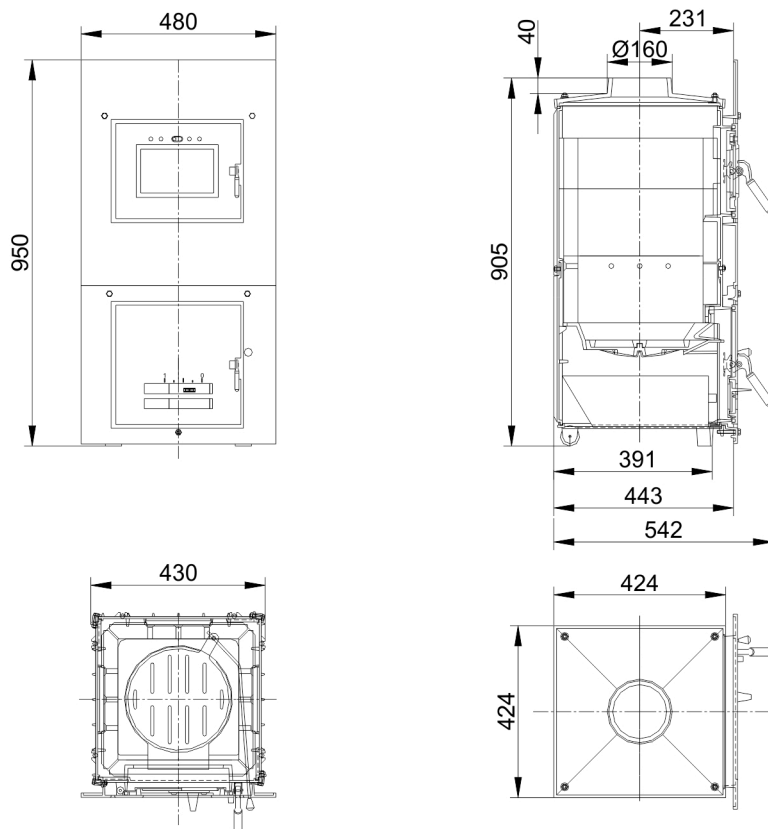

We suggest for CAD planning Palette CAD. Permanent updated drawings: [www.brunner.de](http://www.brunner.de)  
Frames/ flue gas outlet connection/ combustion air supply connection/ front variants/ support bearing are marked in color.

## Planning and installation - E4020.61

Tested according to		EN 13229 W
Values measured at		Rated power <sup>1)</sup>
Suitable for all construction types according to rules		OK
EEl		114
<b>Data for functional demonstration</b>		
Rated heat power	kW	10
Fire wood volume	kg/h	2.2
Combustion performance	kW	12.1
Flue gas mass flow	g/s	6.3
Outlet temperature (before reheating surface)	°C	570
Flue gas temperature after:		
1 x adjoining cast iron radiator (GNF 8/10)	°C	205
2 - 3,5 m ceramic accumulator <sup>2)</sup>	°C	180
Necessary supply pressure	Pa	12
Combustion air consumption	m <sup>3</sup> /h	35
<b>Heating gas temperature (before the hood/dome variant)</b>		
insert flue outlet nozzle	°C	570
<b>Heat distribution</b>		
Insert / reheating surface	%	50 / 40
Glass pane (single / double)	%	10 / -
<b>Cross-section of gratings <sup>3)</sup></b>		
Convection air	cm <sup>2</sup>	800 / 200 / 400
Supply air	cm <sup>2</sup>	800 / 200 / 400
<b>Minimal distances of the fireplace</b>		
to cladding, insulation layer	cm	6
to mounting floor	cm	15
<b>Thermal insulation without / with air gratings <sup>4)</sup></b>		
Mounting wall	cm	16 / 16
Floor	cm	0
Ceiling	cm	36 / 36
Brick lining for combustible wall	cm	10
<b>Weight</b>		
Fireplace / combustion chamber	kg	168 / 45
<b>Meets requirement/limit values for:</b>		
Germany/ Austria / Switzerland / Norway		1.BImSchV (Stufe 2) / - / - / -

- 1) Indications to "Rated power" determined with metallic reheating surface
- 2) Approximate value. Determination according to design characteristics for adjacent storage mass or proof of function provided by calculation
- 3) for fireplace inserts / flue gas pipe / metallic reheating surface
- 4) Values determined with upper air cross- sections; stove cladding is heat emitting